

Technical specifications of the small round wood-stove

measurements (cm)	width	height	depth
stove	39	126,5	39
combustion chamber	26	48	30
fire glass	33	46	
fire door	39	58	
flue pipe connection Ø 15 to ↑ height to pipe socket above			129,5
outside air connection Ø 10 to → or ↓ height to mid connection horizontal			7,5
depth to mid connection vertical			17,5
total weight	chamotte bricks	heat accumulator	
107 kg	15 kg	-	
data for	wood stove		
nominal heat output	5,8 kW		
output range	5,8 - 3 kW		
efficiency	84%		
heating capability*	70 - 210 m³		
amount of fuel	1,8 kg / h		
fire duration	up to 1,5 h		
heat release	up to 2,5 h		
flue gas flow volume	5,28 g/s		
exhaust °C (nozzle)	255 °C		
min/max feed press.	12 / 15 Pa		
CO (13%/O2) [mg/m³]	1208		
CO (13%/O2) [%]	0,097		
dust (13%/O2) [mg/m³]	27		
NOx (13%/O2) [mg/m³]	129		
CxHy (13%/O2) [mg/m³]	34,8		
wall distance, rear	50 cm		
at 4 cm Promat-Iso.	25 cm		
wall distance, side	35 cm		
at 4 cm Promat-Iso.	18 cm		
distance to the front	80 cm		

The Orange S, excellent in quality, energy consumption and environmental performance!

Fulfills the latest standards in burning wood, wood-briquettes and pellets (please see applicable standards).

Please check the instruction manual for this wood burning stove.

Suitable for multiple chimneys.

* depending on stove location in the living area, room isolation, height of the room and amount of fuel

Subject to alterations; errors including printer's errors.

Our specialised stove builders and retailers will assist you with practical advice.

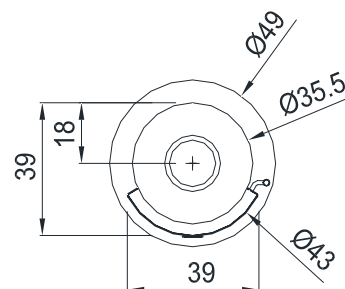
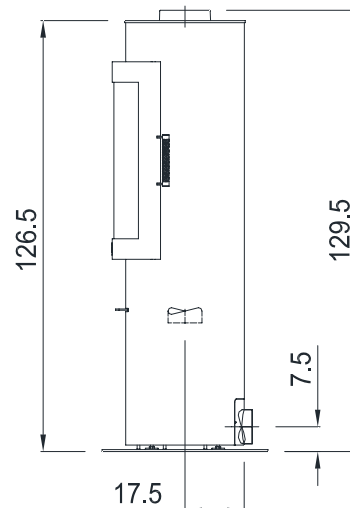
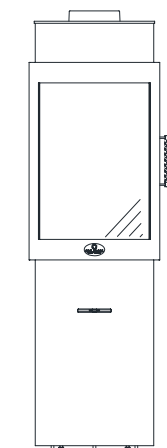

Little round fire log stove, model Orange S

ENR	model	delivery time	
248-2001	Orange S ↑ fixed especially made for log-burning Cannot be upgraded to pellet operation! <ul style="list-style-type: none">• stove body and door in steel anthracite• steel lid anthracite• fire chamber rear wall made of 3 cm heat-storing chamotte• self-locking door with cool design handle	3	
248-2001	Orange S ↑ rotatable especially made for log-burning Cannot be upgraded to pellet operation! <ul style="list-style-type: none">• stove body and door in steel anthracite• steel lid anthracite• fire chamber rear wall made of 3 cm heat-storing chamotte• self-locking door with cool design handle	3	
accessories for the little round fir log stove			
29 232 311	floor protector stainless steel (see accessories)		
29 232 400	floor protector glass (see accessories) especially for this stove type Outside air connection is prepared: Be sure to specify when ordering: outside air connection horizontal or vertical (is included in scope of delivery - rotatable only vertical possible) For other connection accessories, please see list of accessories.		
special features of the small round firewood-stove Orange S			
<p>Specialised for the wood burning process, the small fire chamber fine-tuned for low emission values and comfort.</p> <p>The small round fire-log-stove Orange S, especially for firewood:</p> <ul style="list-style-type: none">• the stove is a rather discreet living room accessory with its slim diameter• fits perfectly in almost every room layout because of its slim figure• self-locking door with an always cool handle• radiant heat is a beautiful and very pleasant heat• more special features and extras at the last pages• choose your stainless steel or glass floor protector from the list of accessories <p>...easy to remove during summer times</p> <p style="text-align: center;">Cannot be upgraded to pellet operation!</p>			